

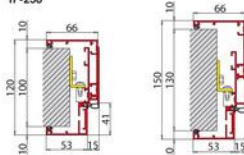

TP-250



| LFM Larghezza Width Breite | HFM Altezza Height Höhe | LP Larghezza Width Breite | HP Altezza Height Höhe |
|-------------------------------------|----------------------------------|------------------------------------|---------------------------------|
| 800 | 2050 | 720 | 2010 |
| | 2150 | | 2110 |
| 900 | 2050 | 820 | 2010 |
| | 2150 | | 2110 |
| 1000 | 2050 | 920 | 2010 |
| | 2150 | | 2110 |

Adatto per muratura da 100 a 130 mm
100 - 130 mm Min Max adjustable wall thickness
100 - 130 mm Min-Max Verstellung für Wandstärken



$$LV = LFM - (30 + 30^*)$$

$$HV = HFM - 40$$

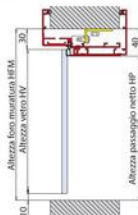

Porte applicabili con stipite TP-250
Available doors with aluminum frame TP-250
Türen erhaltbar mit Aluzarge TP-250



V-509 / V-709
V-409 / V-502 / V-719

$$LV = LFM - (30 + 30^*)$$

$$HV = HFM - 40$$



PO-08

$$LV = LFM - (30 + 33^*)$$

$$HV = HFM - 40$$



PO-09

$$LV = LFM - (30 + 30^*)$$

$$HV = HFM - 40$$



PO-200 / PO-100

$$LA \text{ anta} = LFM - (30 + 30^*)$$

$$HA \text{ anta} = HFM - 40$$

xcmc 062

AN = Alluminio anodizzato
Aluminum anodized
Aluminium Silberfarbig

LV = Larghezza vetro
Glass width
Glasbreite
HV = Altezza vetro
Glass height
Glashöhe

LA = Larghezza anta
Door width
Tur-Breite
HA = Altezza anta
Door height
Tur-Höhe

LP = Passaggio luce
Clear opening width
Lichte Durchgangsbreite
HP = Altezza passaggio luce
Clear opening height
Lichte Durchgangshöhe

LFM = Larghezza foro muratura
Walling up hole width
Einbaulichte Breite
HFM = Altezza foro muratura
Walling up hole height
Einbaulichte Höhe