

Cerniera tutt'altezza P-09

Per applicazione su stipiti battuta da 40mm
 Hinge profile for frame with rebate depth 40mm
 Bandprofil für Falztiefe 40mm

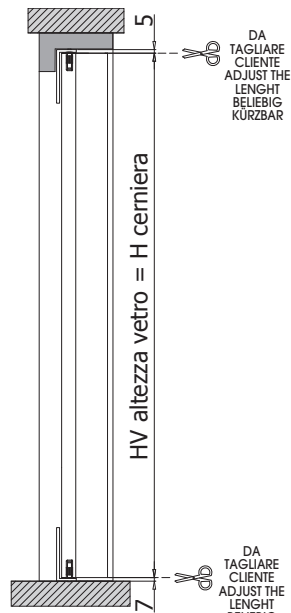

Cerniera altezza standard 2400mm
 Hinge standard height 2400mm
 Band standard Höhe 2400mm



Cerniera con stipiti P-030 e P-040
 Hinge profile on frames P-030 and P-040
 Bandprofil für Aluzargen P-030 und P-040

LV = PL - 31
 HV = H - 23
 LV (con/with P-033) = PL - 43
 HV (con/with P-033) = H - 29

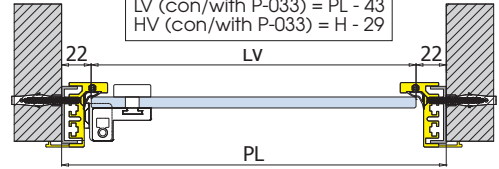

Cerniera con stipiti TP-100
 hinge profile on frame TP-100
 Bandprofil für Aluzarge TP-100

LV = PL - 65
 HV = H - 40
 LV (con/with P-033) = PL - 80
 HV (con/with P-033) = H - 46

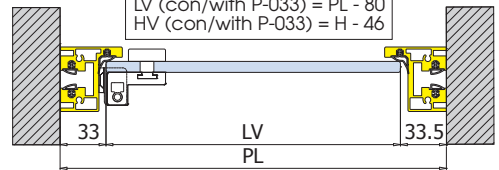

Cerniera ad incollaggio con stipiti TP-250
 hinge profile on frame TP-250
 Bandprofil für Aluzarge TP-250

LV = PL - 55
 HV = H - 34

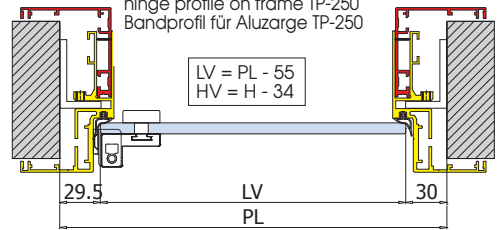

V-121-SD

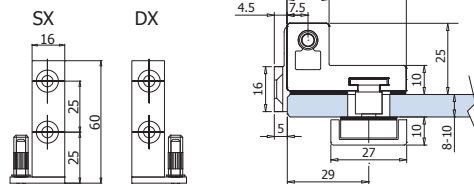

I fori sul vetro possono essere posizionati a piacimento grazie alle bussole regolabili
 The holes can be positioned at will thanks to the adjustable fixing points
 Die Bohrungen können nach belieben durch die verstellbaren Befestigungspunkte positioniert werden.

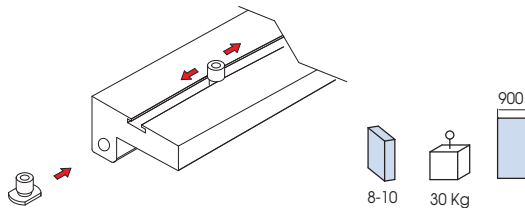

Lavorazione vetro
 Glass preparation
 Glasbearbeitung

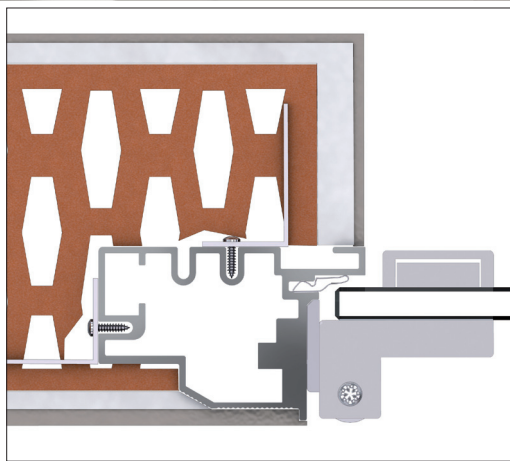
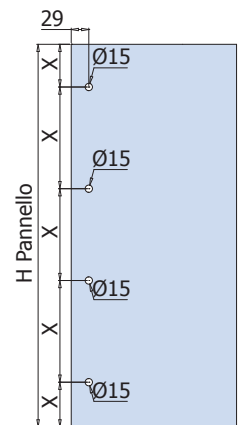

Cerniera applicabile ai seguenti stipiti
 Hinge available for following frames
 Band an folgende Zargen montierbar

P-030 / P-040

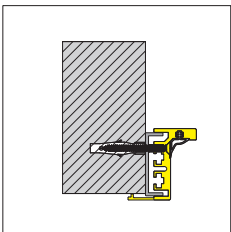

TP-100

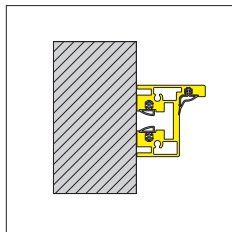

TP-250

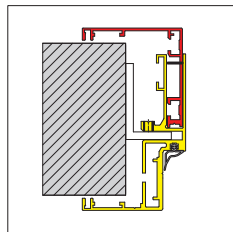

P-070

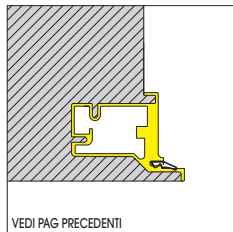

VEDI PAG PRECEDENTI
 SEE PREVIOUS PAGES / SIEHE VORHERIGE SEITEN

P-060

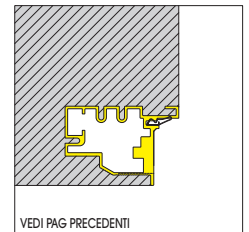

VEDI PAG PRECEDENTI
 SEE PREVIOUS PAGES / SIEHE VORHERIGE SEITEN